

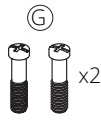

Blackfin Atlantic: Lens Assembly

Blackfin Atlantic Components

- (A) Demo lenses
- (B) Front
- (C) Temples
- (D) Temple tips
- (E) Soft tilt-pads silver
- (F) Self-locking screw x2
- (G) Rim lock screw x2
- (H) Flat washer x2
- (I) Small oval tube x2

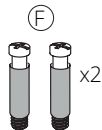
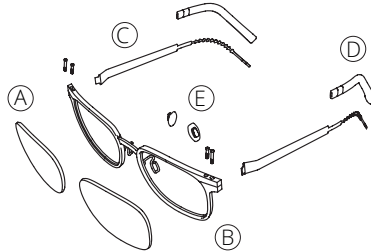

Tools

- (J) Screwdriver PH00

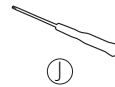

Any kind of defect due to an assembly not in accordance with the following instructions, will not be considered under warranty.

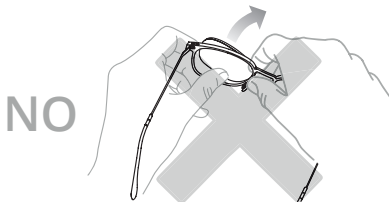

NO

DO NOT

force the lenses out
using hand pressure

Screwdriver
PH00

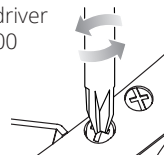

OK

DO NOT

use screwdrivers other than
the suggested model (PH00) in order
to avoid screw's deformations



Detail of inner components

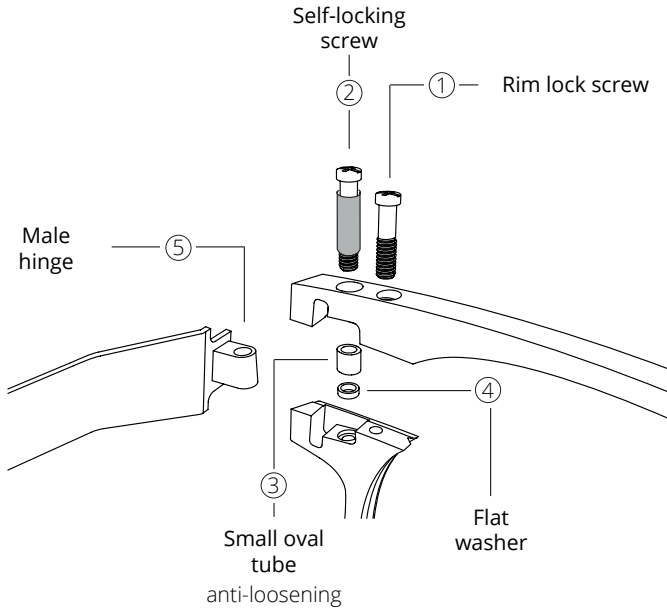

Small oval tube detail

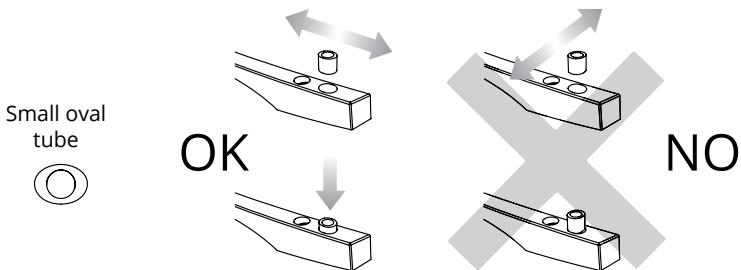

Please note that the anti-loosening small tube is oval, not cylindrical, this means that it must be aligned correctly during the insertion.



WARNING:

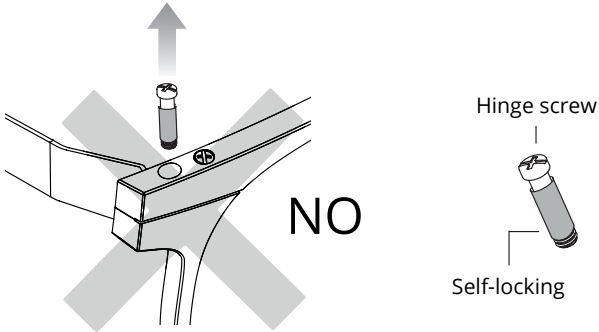

Never unscrew the hinge screw in order not to compromise the anti-loosening system inside. If it is necessary to remove the screw (e.g. temple replacement) it is essential to fit a new screw with a whole (intact) blue self-locking membrane.

It is always possible to tighten this screw in order to increase the friction of the hinge.

To facilitate lens assembly, open the temple completely. This operation is necessary to ensure a proper insertion of the small oval tube in the following lens assembly steps.

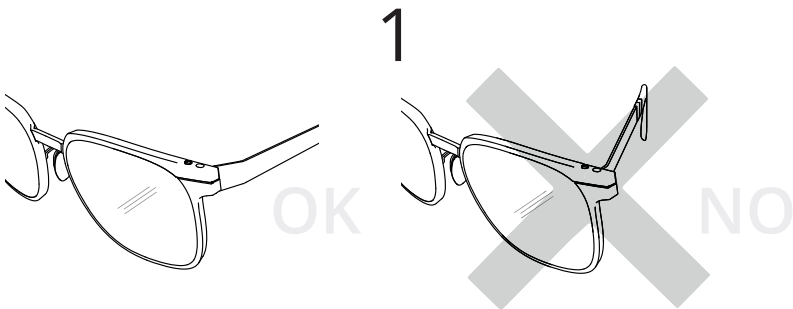



Unscrew and remove the rim lock screw in order to open the rim lock.
The hinge block will remain fastened to the lower part of the front, coming out
freely from the upper part.

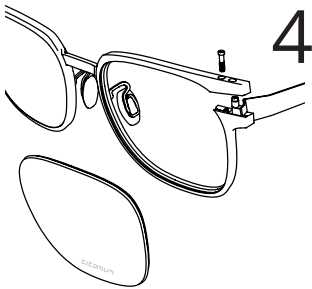
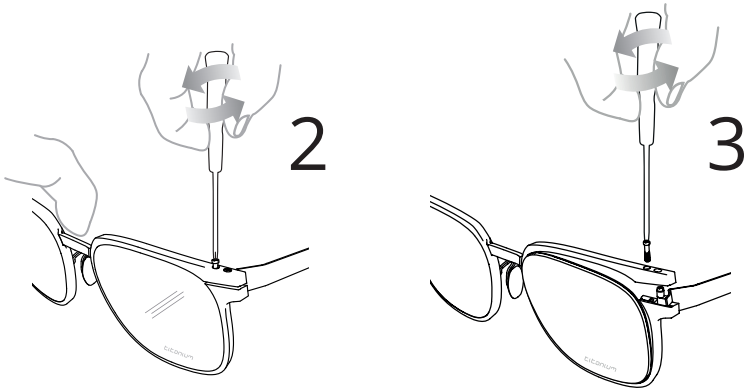

Detail:

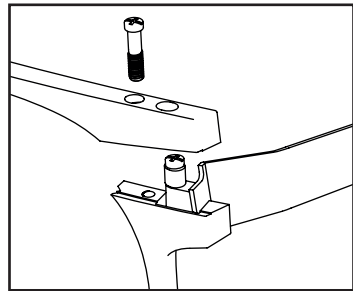

Proceed with lens following the instructions by probing the lens.

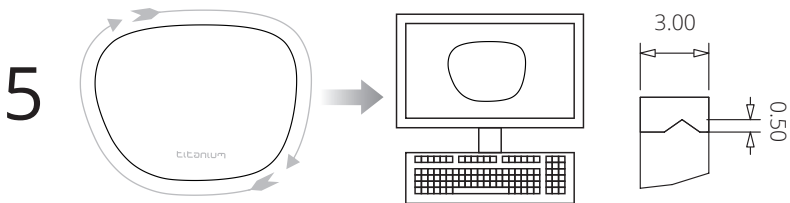



Ophthalmic lens assembly

With the hinge block open, insert the ophthalmic lens, paying attention to reinsert the hinge block into its oval seat at the top of the front.

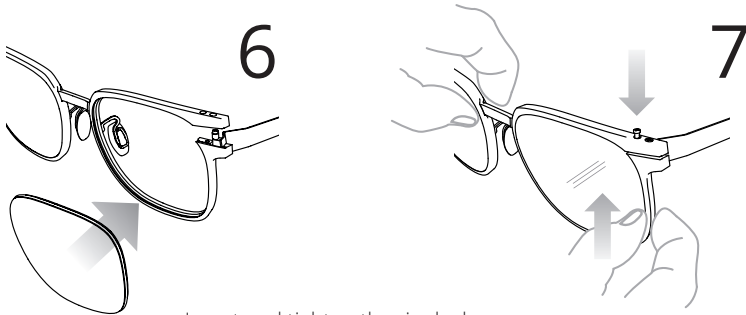

Insert and tighten the rim lock screw.

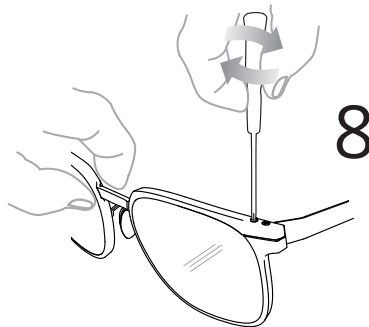

New components

Soft Tilt-Pads and hook

Thanks to the new hook, the pad arms can be adjusted in both support directions.
New soft-touch PVC material.

